

Date: 2/5/2020 Author: J. Prado Project: TX Port Arthur 25th St, 9th Ave, 7th Ave

**Comments:**

THIS TRAFFIC CONTROL PLAN WAS DRAFTED IN ACCORDANCE WITH M.U.T.C.D & TX.D.O.T. SPECIFICATIONS. ROADS SAFE TRAFFIC SYSTEMS PROVIDED THIS DRAFT TO THE CUSTOMER AS A SERVICE & IS TO BE SUBMITTED TO THE AUTHORITY AGENCY FOR REVIEW AND MODIFICATION IF NEEDED. ROADS SAFE TRAFFIC SYSTEMS ASSUMES NO LIABILITY FOR ACCURACY OR VALIDITY.

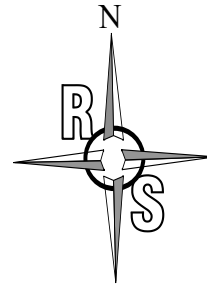

Note: All signs will be set according to the M.U.T.C.D. & TX.D.O.T standards based on the roadway type & speed limits.

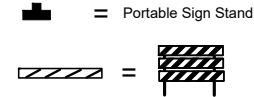

Road Classification	Posted Speed (MPH)	Sign Spacing "X" (Feet)
Conventional Highway	25	100
	30	120
	35	160
	40	240
	45	320
	50	400
	55*	500
	60*	600
	65*	700
	70*	800
75*	900	
80*	1000	
Expressway or Freeway	All Speeds	See Typical Applications (Chapter 6H)**

25th St and 9th Ave closure

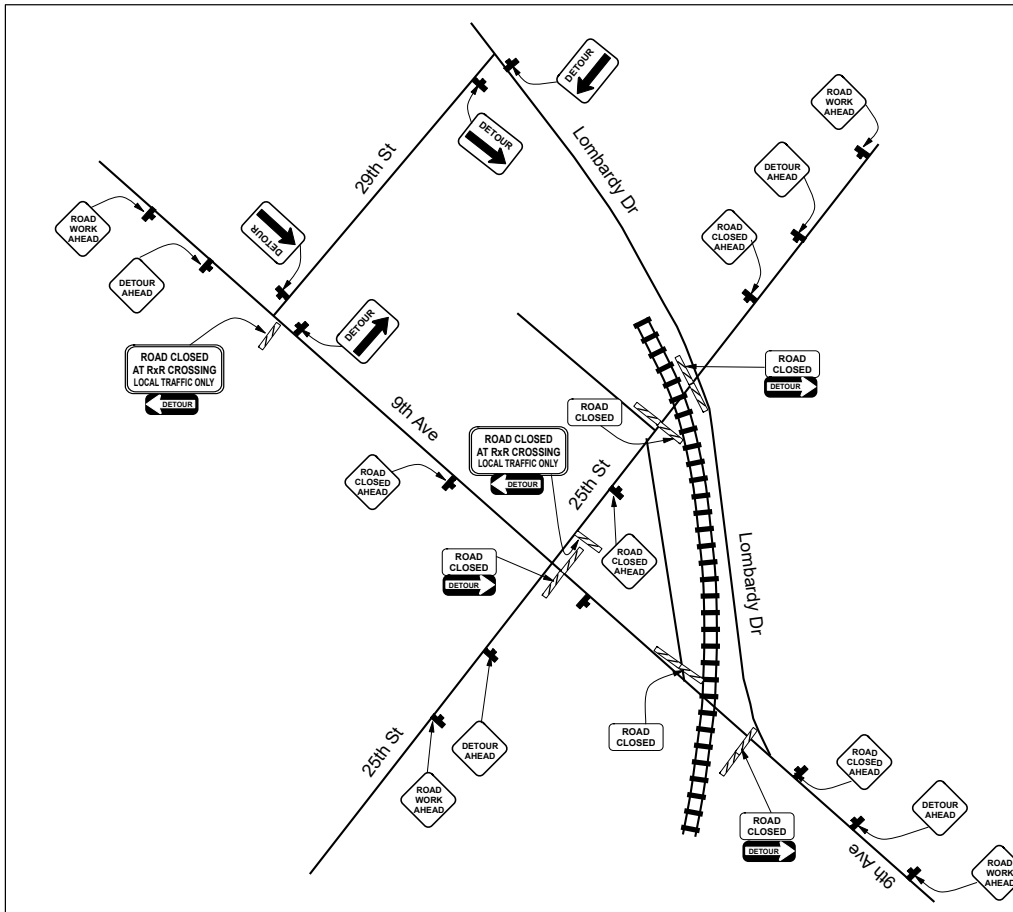

7th Ave Closure

